



KODAK SA101 /SA201

User Manual





S U M M A R Y

I-	Install the central unit	Page 3
II-	Home page	Page 4
III-	Central unit set-up	Page 5
IV-	Install a camera	Page 6
A.	Add a camera	Page 6 - 7
B.	Camera settings	Pages 8 - 10
V-	Add an accessory	Page 11
VI-	Using the scenarios	Pages 12 - 14
VII-	Additional information	Pages 15 - 17

I- Install a central unit

1. Download and install the free KODAK CONNECT application on your mobile phone.



2. Connect the gateway to your internet modem using the Ethernet cable provided with your alarm system then plug in the gateway.

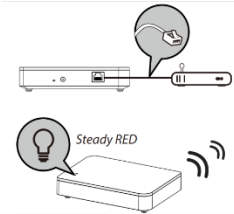

3. In the application, tap “+” to select your preferred gateway.

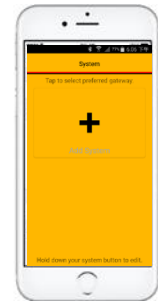

4. The application will automatically detect the device ID number of your gateway. Please enter the name you want to give to the gateway then tap “Next”.

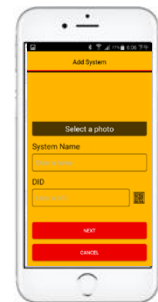

5. Enter a password then tap “Save”.

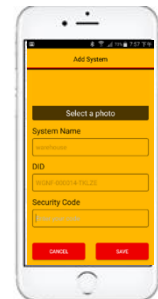

NOTE:

1. The gateway must always be connected to your internet network via the Ethernet cable.
2. If the application does not detect your gateway automatically, you can use manual settings by entering the device ID number and password.
3. The device ID number of the gateway is located at the back of the device, and the default password is 123456.

II- Home page



1 : Panic button, in case of emergency

2 : Arm/Disarm button

3 : Record button

1 : Direct access to your cameras

2 : Access to scenarios

3 : Access to events

4 : Access to advanced settings

III- Central unit set-up



In the home page, tap



The admin default password is 123456.

You will be directed to the following page:



To add emergency contacts in case of alarm

To select the cameras / accessories you want to enable under various modes

Setting the gateway siren

Setting the notifications you want to receive

IV- Install a camera

A. Add a camera

1. In the home page of your Kodak Connect application, tap

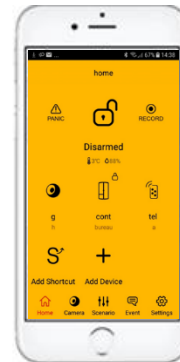

2. Then tap



3. Plug in your camera then tap "Next" to start the installation.

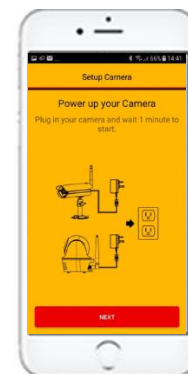

4. Select your Wi-Fi network (make sure your network is on 2.4 GHz) then enter the related password and tap "Next". Wait 90 seconds for your camera to re-start.



5. Choose a name for your camera then enter the password (default password 123456). Your camera is now set. You can access it from the home page.

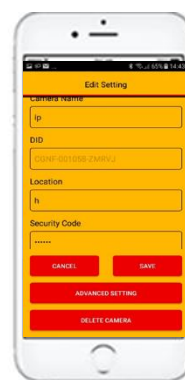

B. Camera settings

1. When you are on the Live Video page of your camera, go to advanced settings (the Admin default password is 123456).

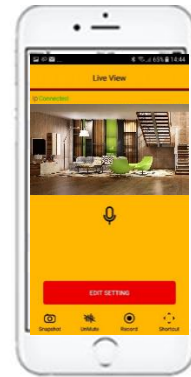

You will be directed to the following page:

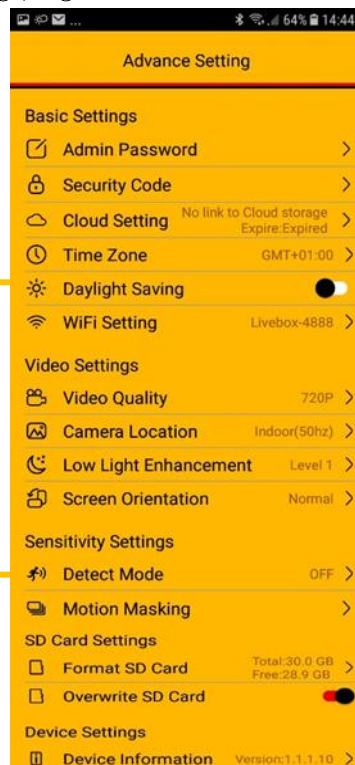

To enable automatic time adjusting

To enable/disable the motion detection

To link your camera to Google Drive (see next page)

Note

1. Please make sure your camera is connected to the same internet network as your mobile phone. The system can only operate under **2.4 GHz** network.
2. If the camera is not detected by the application automatically, you can add it manually by entering its device ID number, which can be found at the back of the camera.
3. If you connect the camera via an Ethernet cable, you can switch to wireless network through the advanced settings menu.
4. If you have already used your camera with the KODAK SECURITY application, make sure you RESET before connecting it to the KODAK CONNECT application.

Google Drive settings for video recording

To set up Google Drive, go to advanced settings then to “Cloud setting”.

- Create a Google Drive account

If you have not yet created a Cloud Storage account while you were setting your camera, be aware you can do it at any time during this process. The assistant will guide you step by step to create your private cloud by using your personal Google Drive account as a storage site. The download time for Google Drive will depend on the quality of your internet connection.

The Cloud Storage account differs from your Google Drive account; it is dedicated specifically to the management of your cameras, whereby each camera is saved on the same Cloud Storage account and then linked to your Google Drive account.

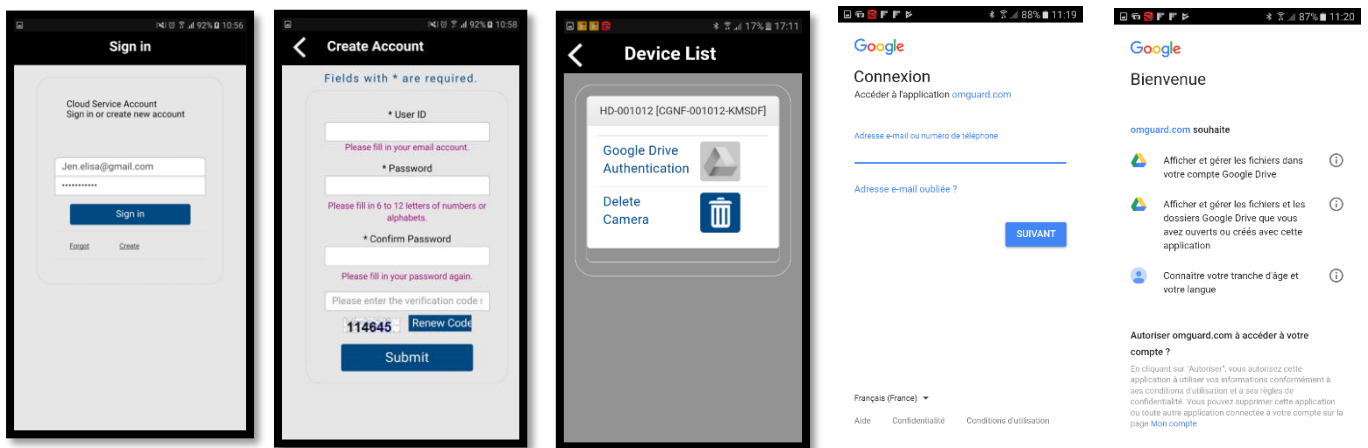

- Manage your cameras

Go to the Device List to see all the cameras saved on your Cloud Storage account. Once you have selected a camera, you can delete it or link it to Google Drive.

You can also delete the camera from the Cloud Storage account to stop using Google Drive to store on the cloud. In this case, the video files will be saved on the SD Card.

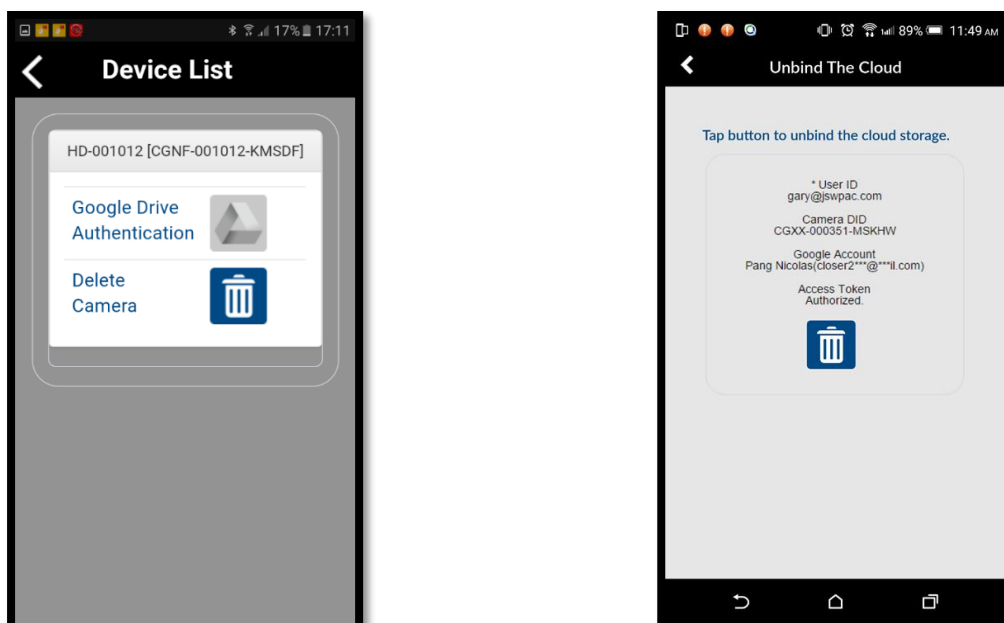

Summary table of potential notifications according to camera settings

Note: The camera is set with a default “Armed” mode.

Kodak Connect	Armed mode	Result
Disarmed	Camera unticked	Recording
Disarmed	Camera ticked	Recording
Armed	Camera unticked	Recording
Armed	Camera ticked	Alarm from the central unit + notification indicating a motion detection by the camera and a recording

If you don't want your camera to start recording each time there is motion detection when you are at home, you should disarm the camera and re-arm it when you leave.

V- Add an accessory

1. In the home page of the Kodak Connect application, tap



2. Select the accessory you would like to add (here, we take the example of a door contact switch).

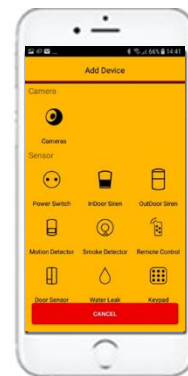

3. Choose a name for your accessory then tap "Next".

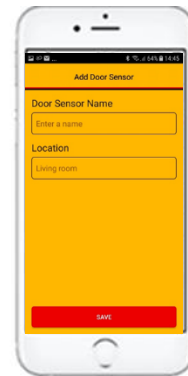

4. Tap "Pair" and follow the instructions. Your accessory is paired with your central unit.

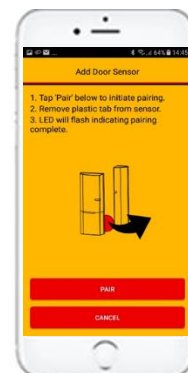

VI- Using the scenarios

To access the scenarios, tap  in the Home Page.

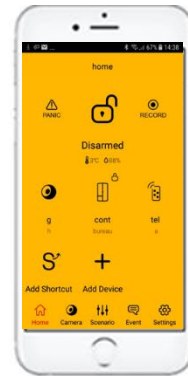

Red = Scenario enabled



White = Scenario disabled

Create a scenario

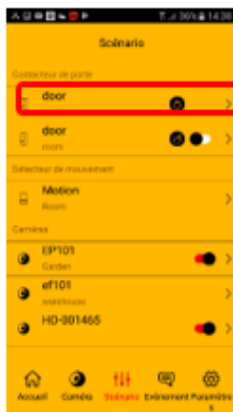

Click on the accessory to create a scenario.

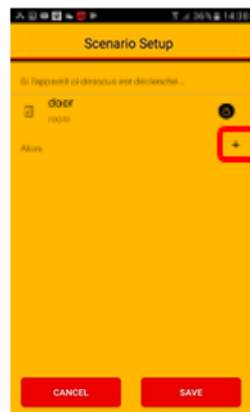

Tap +

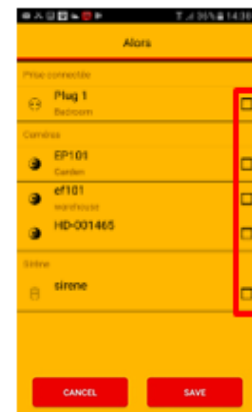

Choose another accessory.

Example



1. If the door contact switch is enabled, the outdoor siren starts ringing.
2. If the camera detects a motion, the smart plug switches the light on.

Icons



Red = accessory enabled



Black = accessory disables

If you have a KODAK Camera, you can create a scenario by using the Preset function. This function allows you to record different points that the camera will focus on if any accessory is triggered.

Example:

On the Live Video page of your camera, go to 

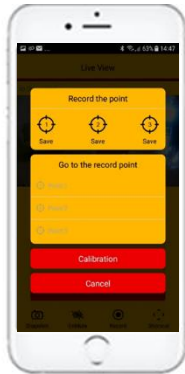
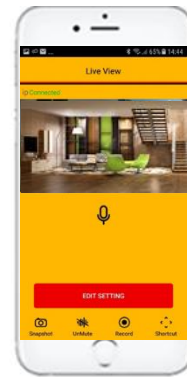

You have now reached the Preset settings of the camera.

This function enables video recording in different points (usually where your accessories have been installed).

To do so, orient your camera towards the point you want to select and tap 1. Proceed in the same manner with the next points.

To link the various points of your camera with the accessories (door contact switches, sensors, detectors etc.), go to the Scenario page as follows:

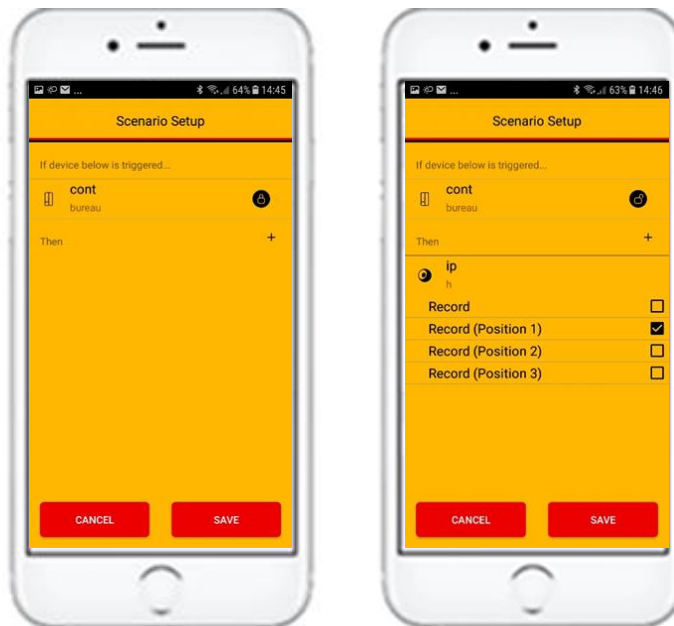

1. Select the accessory you want to link.
2. Select your camera.
3. Select the point the camera must focus on if the accessory is triggered.

VII- Additional information

1 – To enable the SOS mode via the remote control, tap the **!** button for 3 consecutive seconds.



2 – All notifications are displayed in English, regardless which language has been selected, due to the software used in this application.

Examples of notifications :

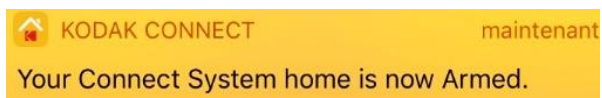

→ Your system is now armed.

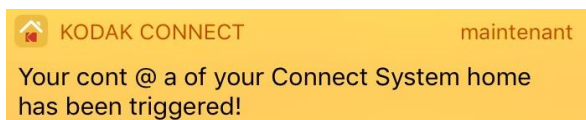

→ Your sensor has been triggered.

➔ Your system is now disarmed.

3 - Our products and applications are updated regularly. To update your system, go to advanced settings then to Firmware update.

4 - You can change the picture of your system. To do so:

When you are on the Home Page of the KODAK CONNECT system, make a long press on the square box, tap to select a picture then choose a picture in your gallery.

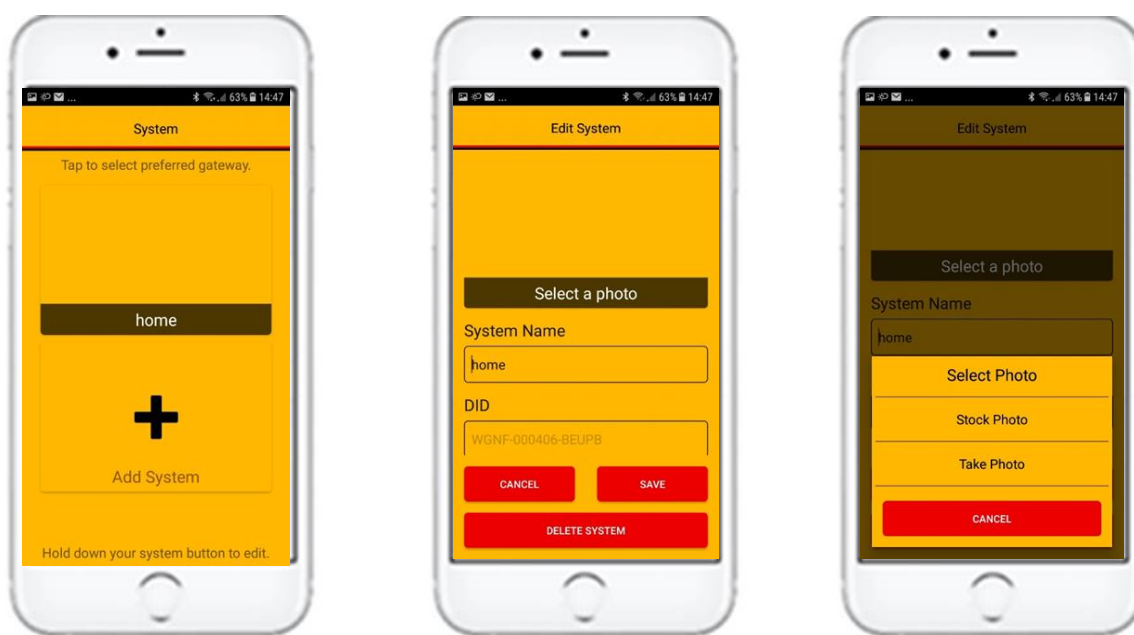

5 - The motion detector goes into sleep mode for about 2 minutes after every detection to avoid repetitive notifications and increase battery life.

6- Passwords :

Gateway password	123456
Camera password	123456
Admin password	123456

You don't have the information you need in this manual?

Check our YouTube channel for installation tutorials.

<https://www.youtube.com/channel/UCWO04hpwAZxBC7-CSKi3hbg/videos>

You can also consult our questions / answers section on our website.

<https://be-connected.com/faq/>

If you still can't find the information you want, please contact our technical support by email indicating the model of your camera, the application you have, and your problem.

support@be-connected.com

